

CERTIFICATE OF LOCATION OF GOVERNMENT CORNER

NORTHEAST Corner of Section 21, Township 107, Range 40, 5TH P.M.

STATE OF MINNESOTA, County of MURRAY

At the corner location shown on the sketch:

- On _____ found a _____
DATE
- left monument as found, lowered monument, removed monument (explain)
- On 12/2/13 placed a survey spike w/seal #43844
DATE

SKETCH OF REFERENCE TIES

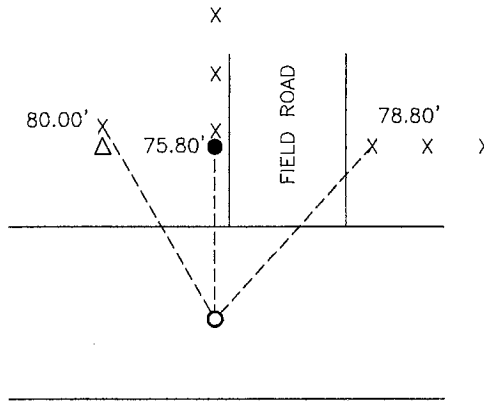

Minnesota State Plane Coordinate
System Murray County Datum
NAD83 (1996)
N: 179363.385
E: 532486.715

MNDOT seal in wood post NE 78.80'
Nail and survey marker in pedestal guard post NW 80.00'
Iron with seal #23008 North 75.80'

Statement of evidence relative to this corner location is on back of page.

I hereby certify that this document and the data contained herein was prepared by me or under my direct supervision.

James V. Johnson
SIGNATURE

2/4/14
DATE

Registration No. 43844

- Land Surveyor, Professional Engineer
- County Surveyor, County Engineer

OFFICE OF THE COUNTY RECORDER

County of _____

I hereby certify that this document was filed in the Co. Recorders office at _____ .M on the _____ day of FEB 5 2014 A.D. 20 _____

County Recorder James V. Johnson
By _____, Deputy

DOCUMENT NO. _____

Statement of Evidence

In 1861, L. Brockmann did the original subdivision of the township.

No Date, MNDOT plans show the corner 0.80' south of center of road.

On March 2, 1998, Zieske Land Surveying detected a metal signal 0.80' south of centerline of the road as per MNDOT plans.

On January 4, 2005, Zieske Land Surveying found monument at the corner.

On December 2, 2013, Bueltel-Moseng Land Surveying set a survey spike with seal #43844 by projecting line from east quarter of Section 16 through Zieske found pin on north side of road right-of-way and going south the recorded distance of 75.80' from said pin. It is in line with fence to the north and 1'± south of painted centerline.